



**REFERENCE:  
E1305**

**COUNTRY OF ORIGIN: PRC**

**TECHNICAL SPECIFICATIONS:**

- for 24V installation
- black housing
- 2x brass pin
- carton dimension 400x260x250 mm
- 40 pcs in bulk box
- weight: 216g

**Warning and installation instructions:**

- Use in accordance to the purpose.
- Install only in specialized workshops or professional services.
- The connector is used to connect the pneumatic brake system of the vehicle with the trailer system.



**www.truck-kamar.pl**

**PHOTO:**

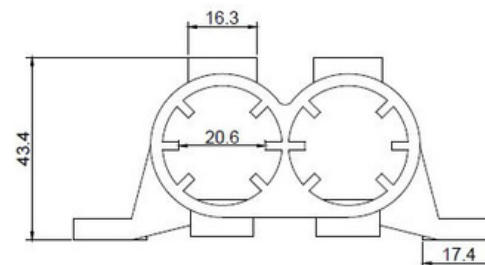
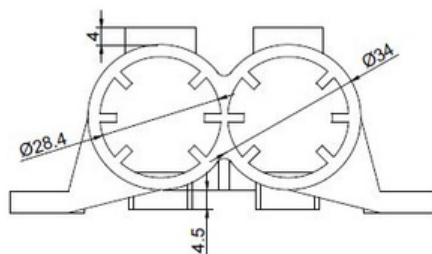

**STARTER SOCKET SW5**

**EAC**

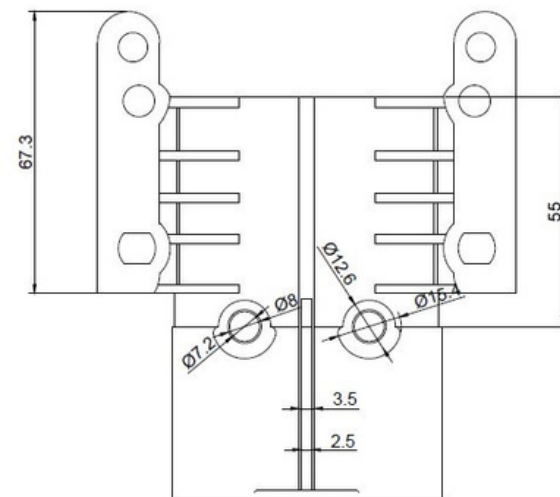
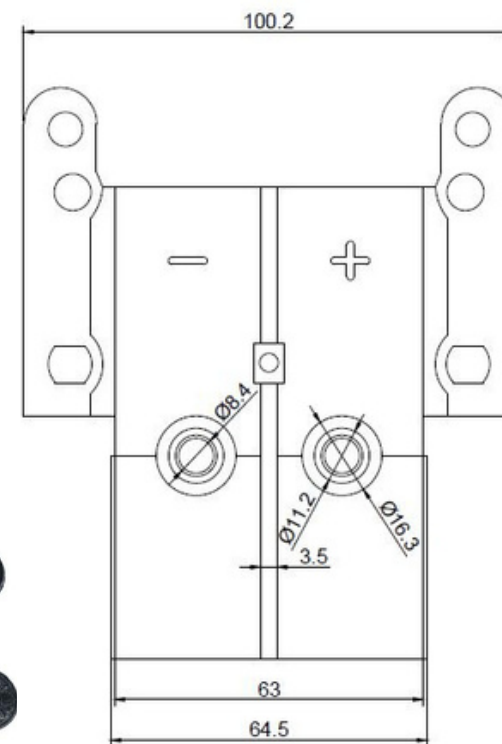

We reserve the right to change technical data and any errors. Photos and specifications are for reference only, and the actual product may vary slightly. Reproduction in whole or parts of the catalog without written authorization is prohibited.